

XB-914 BUOY DEPLOYMENT PIPE

INSTALLATION GUIDE



Figure 1: XB-914 Buoy Deployment Pipe Assembly

Overview

Deployment pipe extensions are easily installed in the built-in buoy pass-through tubes on the XB-200 data buoy to provide extra protection for sensitive monitoring equipment. The XB-914 deployment pipe is a 4" slotted PVC pipe with 36" of total length. The bottom of the deployment pipe is fitted with a stop bolt to keep sensors in place.

What's Included

- (1) 4" W x 36" L deployment pipe
- (1) 1/2"-13 x 5-1/2" Hex head bolt
- (2) 1/2"-13 Hex nuts
- (3) 5/16"-18 x 2" Hex head bolt
- (3) 5/16" Flat washers
- (3) 5/16" Split lock washer

Tools Required

- 1/2" Socket or wrench
- 3/4" Socket or wrench

Deployment Pipe Installation on the Buoy

- 1 Locate the three sensor pass-through tubes on the buoy.
 - a. For 2-point mooring setups, locate the tube that is perpendicular to the bottom eye-nuts. Use this tube to avoid interference with the mooring lines.
- 2 Use a 1/2" socket or wrench to remove the three bolts from the top plate of the pass-through tube.

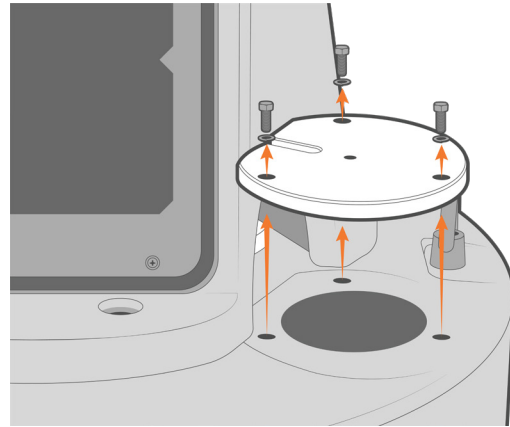

Figure 2: Remove the white top plate on the tube.

- 3 Slide the deployment pipe into the tube and align the bolt holes between the buoy and the pipe.

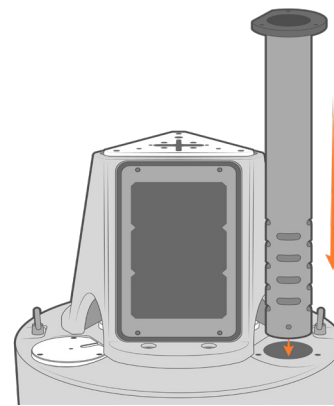

Figure 3: Install the buoy deployment pipe.

- ④ Install the 5-1/2" Hex head bolt through the bottom hole on the deployment pipe.
- By hand, install one of the hex nuts onto the bolt. Leave a 1/4" gap between the nut and the edge of the deployment pipe.

By hand, install the second hex nut until it is in contact with the first nut. Take two wrenches and tighten the nuts against each other.

- Ensure there is still a 1/4" gap between the nuts and the deployment pipe and that the nuts cannot be unscrewed by hand.
- The bolt is intended to move freely with the 1/4" gap.

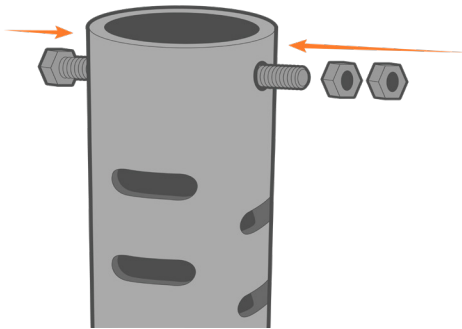

Figure 4: Install the stop bolt.

- ⑤ Ensure the sensor that will be inserted into the deployment pipe contains a guard to protect any probes, wipers, or optics.
- Connect the sensor cable and insert the sensor into the pass-through tube until it reaches the stop bolt at the bottom of the pipe.

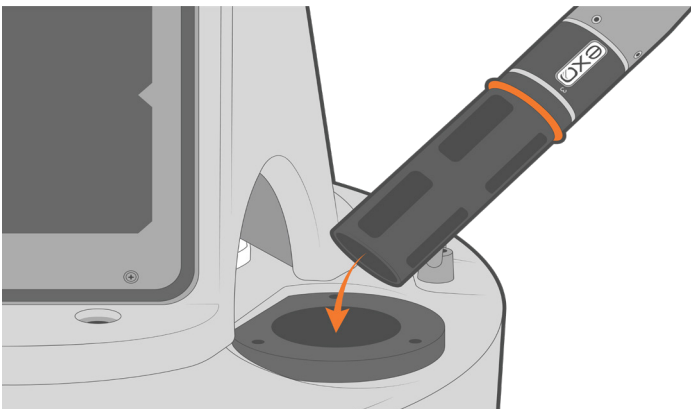

Figure 5: Install the sensor into the deployment pipe.

- ⑥ Route the sensor cable through the opening on the pass-through tube cover.
- Tighten down using the (3) 2" hex head bolts, lock washers, and flat washers and 1/2" socket or wrench.

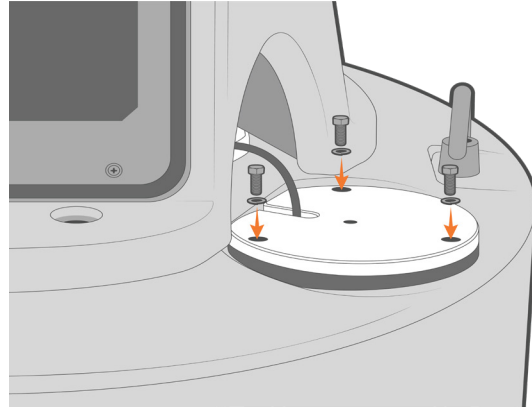

Figure 6: Install the sensor into the deployment pipe.