

GARMIN GPS 24XD RECEIVER BUOY MOUNT

INSTALLATION INSTRUCTIONS FOR CB-450 AND SMALLER BUOY MODELS



Figure 1: NexSens CB-24XD-M Weather Sensor Buoy Mount.

Overview

The NexSens CB-24XD-M Garmin GPS 24xd Receiver Buoy Mount provides a means of securely installing a Garmin GPS Receiver to a CB-Series data buoy solar tower.

What's Included

CB-24XD-M Parts

- (1) Weather station mount
- (1) 3/8" Split lock washer
- (1) 3/8" Flat washer
- (1) 3/8-16 x 1-3/8" Hex cap bolt
- (1) Garmin box (comes with GPS unit)

CB-24XD-M Installation on Buoy Solar Tower

- 1 Grab the following from the Garmin GPS box:
 - O-ring from the Marine Antenna Surface Mount bag
 - Marine antenna pole mount
 - Garmin GPS Receiver

- 2 Route the GPS cable through the bottom of the marine antenna pole mount.
 - Place the O-ring on the pole mount around the GPS cable.

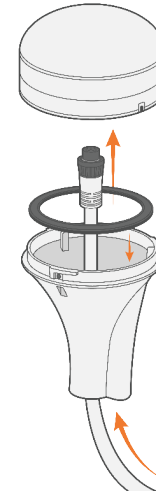

Figure 2: Route the GPS cable through the antenna mount.

- 3 Plug the connector into the GPS receiver and turn counter-clockwise to tighten.

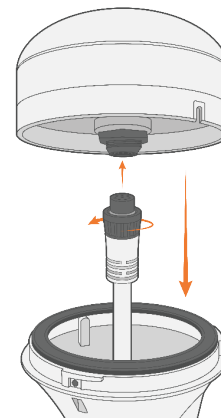

Figure 3: GPS Receiver cable connection.

- ④ Align the receiver on the mount and turn clockwise until the receiver clicks into place.
- The holes will align on the receiver and antenna mount.

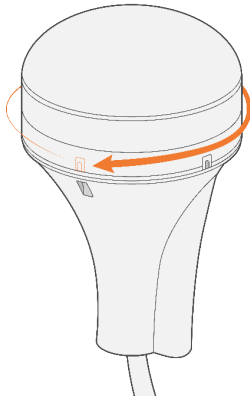

Figure 4: GPS Receiver attachment to antenna pole mount.

- ⑤ Retrieve one of the headless hexagon screws from the Garmin box and insert into the open hole on the side of the mount.
- Tighten using a 1.5-metric allen wrench until flush.

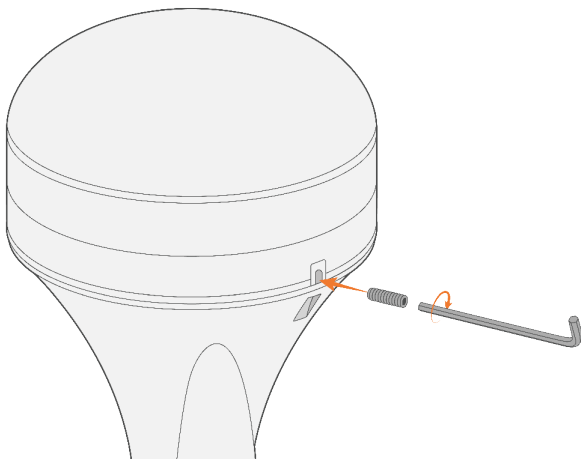

Figure 5: Insert a headless hexagon screw to secure the receiver.

- ⑥ Using a 9/16" socket wrench, remove the top white plate on the solar tower and the bottom hex cap bolt from the CB-24XD-M mount.
- Thread the CB-24XD-M mount into the bottom of the antenna mount until flush.
 - Route the hex cap bolt through the bottom of the white top plate and thread into the CB-24XD-M mount. Tighten using the 9/16" socket wrench.

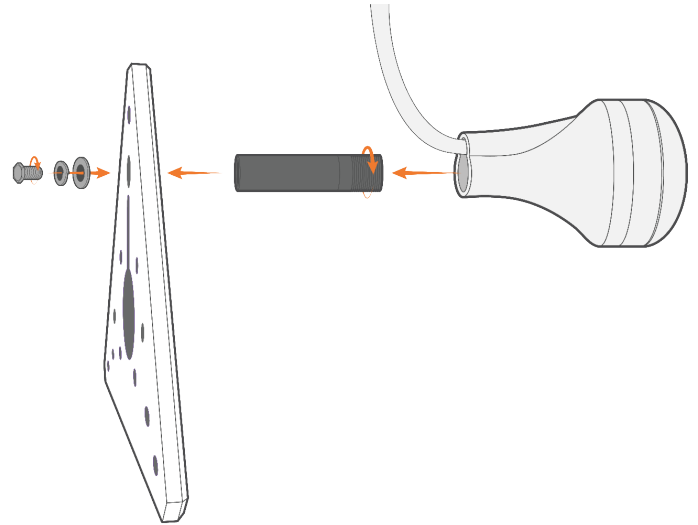

Figure 6: Secure the GPS to the white top plate.

- ⑦ Re-install the top white plate and route the GPS cable through the center hole to the data logger.

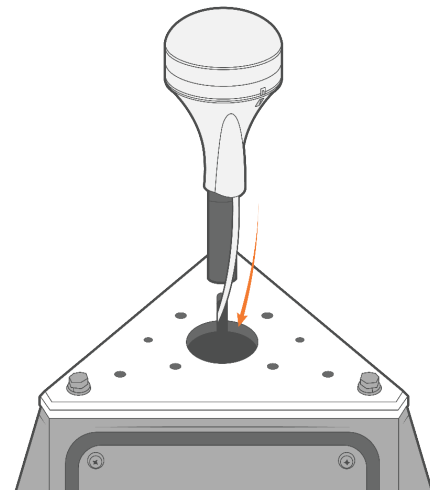

Figure 7: Route the GPS cable through the top white plate.